

# DRB SERIES Right Angle DIP Solder D-SUB

## Specifications/技术参数:

### Electrical/电气特性:

Current Rating (额定电流): 3A  
 Withstand Voltage (耐压值): 1000VAC for one minute  
 Contact Resistance (接触电阻): 20mΩ max  
 Insulation Resistance (绝缘电阻): 5000MΩ min  
 Operating Temperature (工作温度): -40°C ~ +105°C

### Physical/物理特性:

Insulator (塑胶本体): Glass Filled Polyester  
 Flammability Rating (防火等级): UL 94V-0  
 Contacts (接触件): Copper alloy  
 Contacts plating (接触件电镀): Selective gold plating on surface contact area

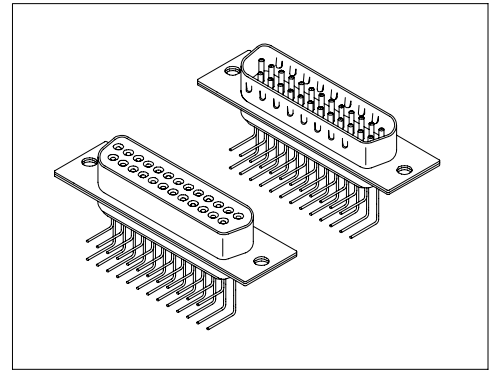

## Dimension/尺寸: mm

### Male/公针:

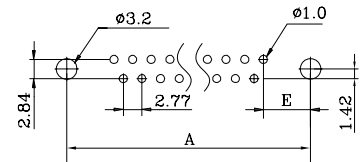
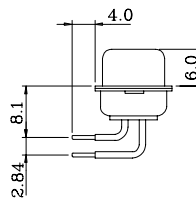
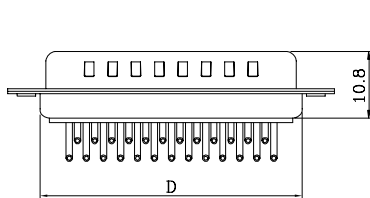
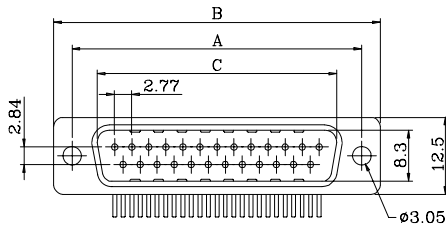

PCB LAYOUT  
线路板布局图

### Dimension/尺寸:

Poles	Dim A	Dim B	Dim C	Dim D	Dim E
9	25.0	30.8	16.92	19.2	6.96
15	33.32	39.2	25.25	27.7	6.96
25	47.04	53.1	38.96	41.1	6.90
37	63.5	69.4	55.42	57.3	6.82

### Female/母孔:

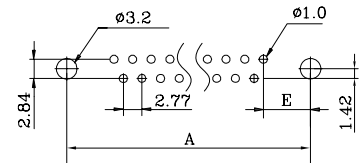
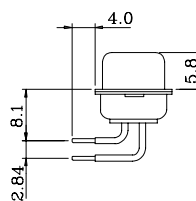
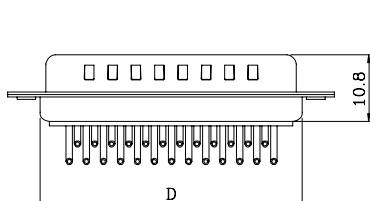
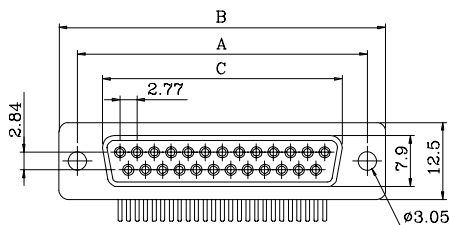

PCB LAYOUT  
线路板布局图

### Dimension/尺寸:

Poles	Dim A	Dim B	Dim C	Dim D	Dim E
9	25.0	30.8	16.3	19.2	7.67
15	33.32	39.2	24.6	27.7	6.99
25	47.04	53.1	38.3	41.1	6.99
37	63.5	69.4	54.8	57.3	7.07

## Mounting Options/安装选项:

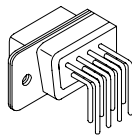
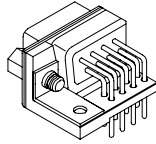
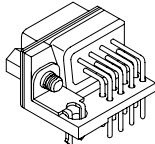
<p><b>AA</b> Riveted front and rear shell with <math>\phi 3.05\text{mm}</math> Hole</p>  <p>带<math>\phi 3.05\text{mm}</math>光孔</p>	<p><b>CBL</b> Riveted ground tabs pre-loaded #4-40 UNC Hex screws</p>  <p>前锁#4-40六角螺柱, 后L片</p>	<p><b>CBH</b> Riveted ground hooks pre-loaded #4-40 UNC Hex screws</p>  <p>前锁#4-40六角螺柱, 后鱼叉</p>
---	---	--

## Ordering Code/订购型号:

1
2 3 4
5
6

DRB
—
15
F
G
—
AA
—
3

**1. Series No./系列号:**

DRB

**2. Poles/位数:**

9、15、25、37

**3. Contacts type/接触件类型:**

M = Male machined contact(车制公针)

F = Female machined contact(车制母孔)

**4. Contacts plating/接触件电镀:**

S = Selective Gold(半金)

G = Gold flash(全金)

G5 = 5 $\mu$ " Gold(镀金5 $\mu$ " )

**5. Mounting options/安装选项:**

AA = Riveted front and rear shell with  $\phi 3.05\text{mm}$  Hole

CBL = Riveted ground tabs pre-loaded #4-40 UNC Hex screws

CBH = Riveted ground hooks pre-loaded #4-40 UNC Hex screws

**6. Insulator color/胶体颜色:**

1 = White(白色)

2 = Blue(蓝色)

3 = Black(黑色)

4 = Grey(灰色)